

ROOMS 1, 3, 4, 5, 6, 7 & 9
 MINIMUM TIMBER JOIST
 C24 72X120 c/c 400mm
 max span 3270mm

ROOM 8 and ROOM 2
 MINIMUM TIMBER JOIST
 C24 72X170 c/c 400mm
 max span 4920mm

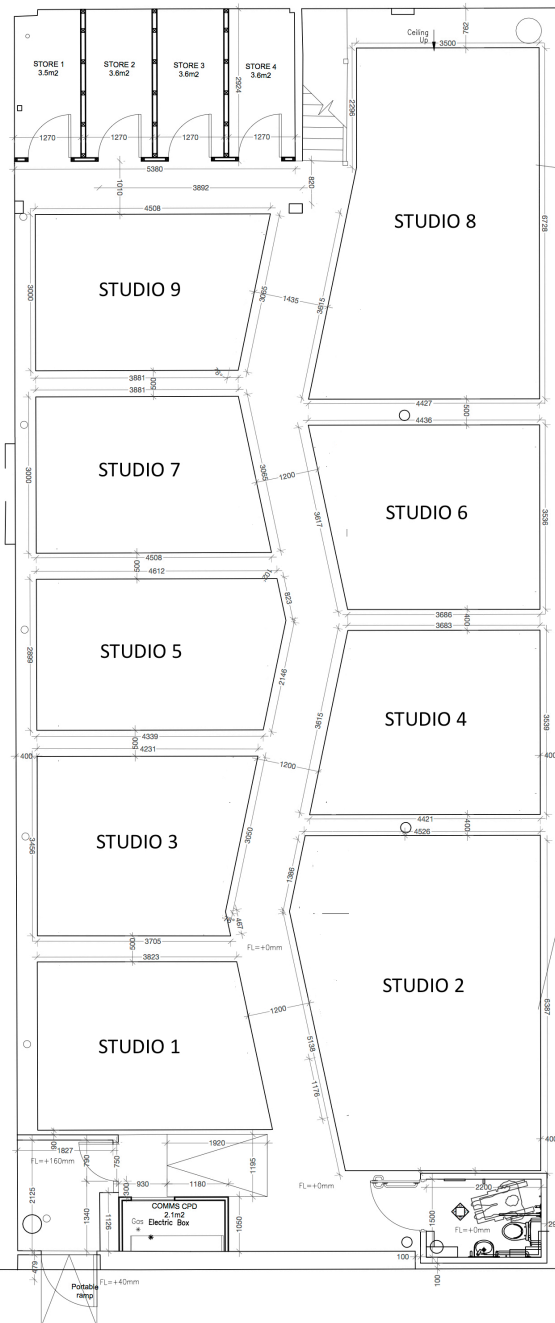

Based on Trada Span Tables
 4th Edition - Table 7.2
 Permissible clear spans for
 joists for flat roofs - access for
 maintenance and repair only

General Notes:
 All dimensions to be checked on site. Only to be scaled for planning and building regulations purposes. To be read in conjunction with full drawing pack and architectural specification, including specialist co-consultants drawings and specifications.

© KVIST architecture & design 2018

| Rev: | Desc: | By: | Date: |
|------|----------------------------------|-----|----------|
| A | Larger pod replaced with 3 pods | CS | 31.05.18 |
| B | Outer dimensions on pods | SB | 04.06.18 |
| C | DWC added | MD | 16.07.18 |
| D | Lobby added | MD | 17.07.18 |
| E | Visitor panels and joist c/c 400 | MD | 19.07.18 |
| F | Eurocode 5 Span Tables | MD | 20.07.18 |



CLIENT:
 TEN87 STUDIOS

ADDRESS:
 Fountayne Road

SCALE:
 1:50 @ A1

Drawing Title:
 GA
 FLOOR PLANS

Drawing No.: 17-1129 PP01
Date: Jul'18
Rev No.: F

